

UNITED®

INSTRUCTION MANUAL

Tower Fan



MODEL: UTF-795

Read carefully these instructions and store them for future reference

1. WARNING SYMBOLS



Read the instructions



Caution



Class II Equipment

2. GENERAL SAFETY INSTRUCTIONS



Read this instruction manual thoroughly before using the appliance and save it for future reference and if necessary, pass the instruction manual on to a third party.

WARNING: When using electrical appliance, basic safety precautions should always be followed to reduce the risk of fire, electrical shock and personal injury.

General

- Check if the electrical specifications of this appliance are compatible with your installation.
- This appliance can be used by children aged from 8 years and above and people with reduced physical, sensory or mental capabilities or lack of experience and knowledge if they have been given supervision or instruction concerning use of the appliance in a safe way and understand the hazards involved.
- Children should not play with the appliance.
- Cleaning and user maintenance shall not be done by children without supervision
- To protect against electrical hazard, do not immerse in water or other liquids. Do not use water nearby.
- This appliance is for indoor use only.
- Do not place objects on top of the unit.
- Do not unplug the unit if your hands are wet, electrical shock could occur.
- Do not carry the appliance while it is operating.
- Place it on a secure and level area. Keep out of reach of children to prevent any accident.
- Unauthorized use and technical modifications to the appliance can lead to danger to life and health.
- Do not push any object into the appliance. Do not disassemble the appliance.

Electrical safety

- If the supply cord is damaged, it must be replaced by the manufacturer, its service agent or similarly qualified people to avoid a hazard.

3. APPLIANCE SPECIFICATIONS

| Technical Characteristics | |
|---------------------------|----------|
| Rated voltage | 220~240V |
| Rated frequency | 50 Hz |
| Rated wattage | 45 W |
| Protection class | II |

4. INSTALLATION INSTRUCTIONS

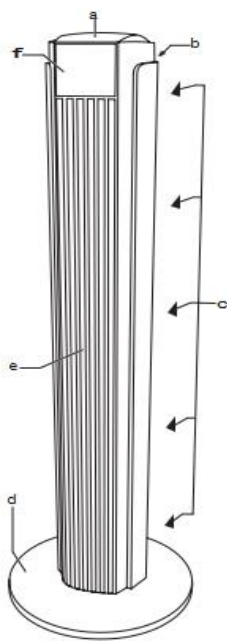

- a. Control panel
- b. Handle (behind unit)
- c. Air inlet
- d. Stand
- e. Air outlet
- f. Display
- j. Remote control

Assembly

- Take the fan out of the package and check the device as well as the scope of delivery mentioned above. Please contact the vendor if any part is missing or has been damaged.
- First assemble the pedestal. Then mount the pedestal to the fan. Make sure that you route the cable through the strain-relief, tighten it and do not damage the cable in the process.
- Then fix the pedestal to the fan using the mounting screws.

Stand

- The stand must be fitted on the fan before use. The stand is supplied in two sections, upper and lower. The lower section includes a guide for the power cable.

Cable guide - Assembly screws

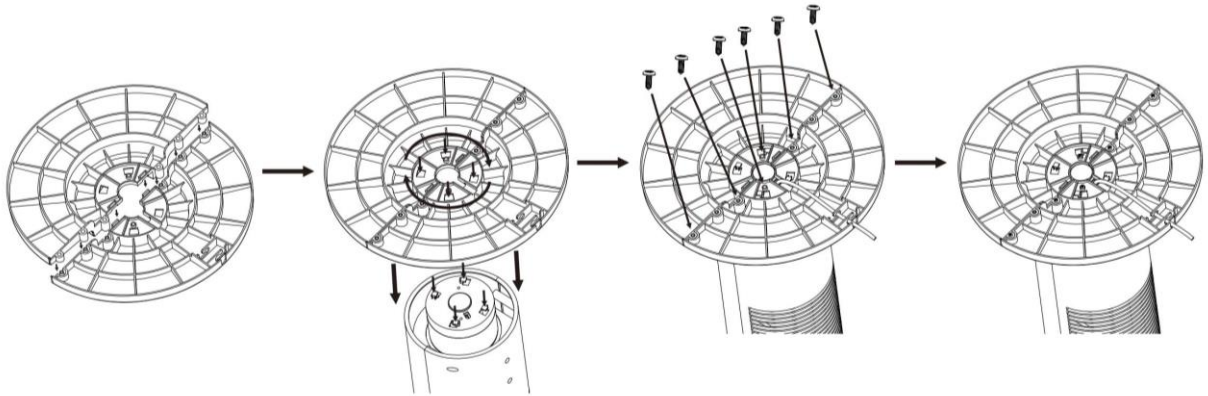

- Lay down a cushion for protection and stand the fan on its top surface so that the base is visible. An assistant is helpful to hold the fan steady while the base is being fitted.
- Place the upper half of the stand onto the base of the fan. This will align with three of the fixing guides on the base.
- Place the lower half of the base over the upper half, ensuring that the power cable is not trapped under the stand.
- Use the supplied 6 screws to fix the two halves of the stand together. Use the 2 long screws in the middle. Then use 2 short screws on each of the sides, making a total of 4 short screws.
- Tuck the power cord into the guide so that it is held close to the underside and exits through the slot in the side of the stand as shown

5. OPERATION INSTRUCTIONS

- Set the fan on a dry level surface.
- Plug the cord into a suitable 220~240V AC outlet.
- Turn the fan on by pressing the POWER button on the remote control or on the control panel. The appropriate LED indicator on the top of the fan will illuminate.
- Turn the fan off by pressing the POWER button again.
- The speed is adjusted by repeatedly pressing the SPEED button on the remote control or on the control panel. The appropriate LED indicator on the top of the fan will illuminate.

Adjustments

- **POWER:** To turn on or off the fan, press the POWER button on the remote control or control panel.
- **SPEED:** The speed is adjusted by repeatedly pressing the Speed button on the remote control or on the control panel. The appropriate LED indicator on the top of the fan will illuminate.
- **OSCILLATION:** To start and stop oscillation of the fan body, push the OSC button on the remote control or on the control panel. The appropriate LED indicator on the top of the fan will illuminate.

- **TIMER:** To start and stop the timer, press the TIMER button on the remote control or control panel to cycle through the timer (from 0.5-hour to 7.5-hours, in 0.5-hour increments) settings. The appropriate LED indicator on the front of the fan will illuminate.
- **NATURAL / SLEEP BREEZE:** For a natural breeze movement, press the MODE button once. This will automatically vary as the fan speeds faster and slower. Press the MODE button again to activate sleep control. This function slows the fan's speed down, press the MODE button a third time to switch off the natural and Sleep functions. The appropriate LED indicator on the top of the fan will illuminate

6. REMOTE CONTROL

The remote control requires batteries for operation. To install the batteries, simply depress the back of the remote control, with your thumb in the indentations, and remove the cover. Insert the batteries according to the diagram shown inside. Replace the cover.



| Key | Function |
|-------|--|
| POWER | Switches the device ON or OFF |
| SPEED | Changes the speed level of the fan 0-I-II-III |
| OSC | Turns the oscillation on or off |
| TIMER | Turns the timer function on. 0.5-7.5H |
| MODE | Changes the mode of the fan (normal / natural / sleep) |

7. MAINTENANCE / CLEANING

Follow these instructions to correctly and safely care for your fan. Please remember:

- Always unplug the fan before cleaning or assembly.
- Do not allow water to drip on or into the fan motor housing.
- Be sure to use soft cloth, moistened with a mild soap solution.
- Do not use any of the following as a cleaner, petrol, thinners or benzine.

CORRECT DISPOSAL OF THIS PRODUCT



This marking indicates that this product should not be disposed with other household wastes throughout the EU. To prevent possible harm to the environment or human health from uncontrolled waste disposal, recycle it responsibly to promote the sustainable reuse of material resources. To return your used device, please use the return and collection systems or contact the retailer where the product was purchased. They can take this product for environmental safe recycling.

DECLARATION OF CONFORMITY

Herewith, we state that this product complies with the requirements of below directives:

EMC-Directive: 14 / 30 / EU

Low Voltage Directive: 14 / 35 / EU

ErP Directive 09 / 125 / EC

CE Marking: 93 / 68 / EEC

RoHS Directive: 11 / 65 / EU & 15 / 863 / EU

The detailed declaration of conformity can be found at
www.united-electronics.gr



KALLIOPI KARYDA & CO, LP

87A, 17is Noemvriou, P.C. 55535,

Pylaia, Greece

Tel. +30 2316 00600 - Fax. +30 2316 006650

www.united-electronics.gr